

PS3SS12

Piastra singola Cetop 03 in ghisa con attacchi laterali
Basic element Cetop 03 in cast iron with side ports

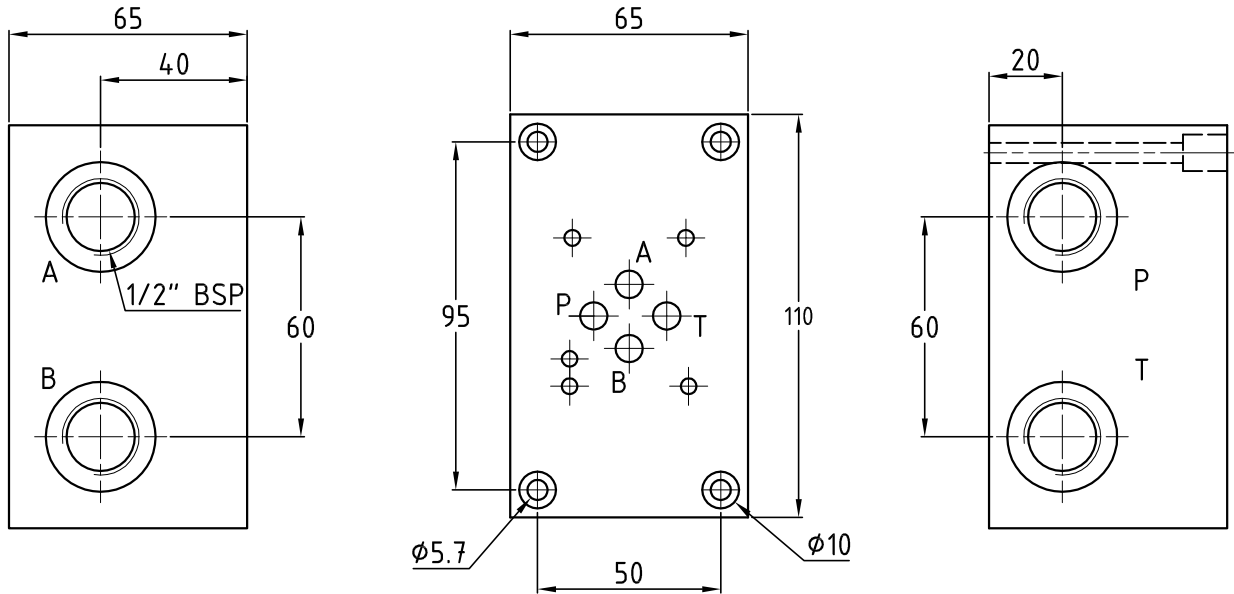

Peso\Weight 2,6 kg

Esempio di ordinazione - Ordering code

PS3 SS 12

Piastra singola Cetop 03 in ghisa
Single subplate Cetop 03 in cast iron

SS = attacchi laterali
SS = side ports

12 = attacchi 1/2" BSP
12 = ports 1/2" BSP